

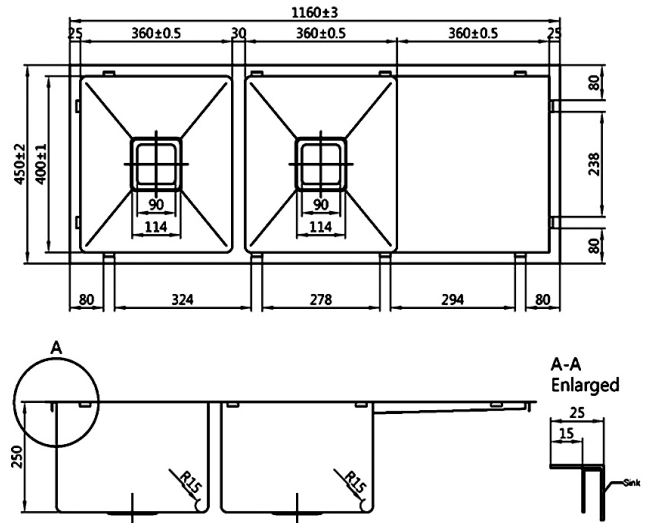

REVERSIBLE



SPECIFICATIONS

(All measurements are in millimeters)

Description:

Deep range Double Bowl & Drainer w/ corner R:15mm

Sink Dimensions:

1160W x 450H x 250D

Bowl Dimensions:

2 x [360W x 400H x 250D]

Min Cabinet

Size: 800mm

Installation:

Flush mount, Inset-mount or Under mount

Material:

1.2 mm 304 Stainless Steel

Tap Holes:

NO tap hole only

Outlet:

90mm basket wastes included

Cut Out Templates:

Yes

Warranty:

25 years replacement products or parts.

*NOTE: Always use the physical product measurements for cut-outs as the manufacturer's template is a guide only and may differ from the actual product dimensions over time.

Optional Accessories

Board S1300



Glass Board R1215



Colander PKSCL



Colander DT04



Bench Protector



Drainer DT05



Drainer KC-09



Drainer TrayST940



Roll up drainer RD2



Space Saver Spazio Kit

